



Coningswath Road, Carlton, Nottinghamshire NG4 3SG

Guide Price £120,000

GUIDE PRICE: £120,000 - £130,000

LOOKING FOR A PROJECT?

Then your search will finish here with this three bedroom semi detached house. The property requires a full internal refurbishment but is situated in a popular location with good transport links and school catchments.

To the ground floor there is a good sized lounge and kitchen along with a ground floor bathroom.

The first floor has three bedrooms.

Outside there are good sized gardens.

No upward chain.

PLENTY OF POTENTIAL

360° VIRTUAL TOUR AVAILABLE



ACCOMMODATION

Ground Floor:

Entrance Hall

The hall has a UPVC door and provides access to the ground floor accommodation

Living Room

13'1" x 12'1" (4.00 x 3.70)

The living room has a double glazed window, a radiator, TV point and a gas fire

Kitchen Diner

11'5" x 10'5" (3.50 x 3.20)

The kitchen has a range of base and wall units, a stainless steel sink, space and plumbing for a washing machine, space for a cooker, laminated flooring, a radiator and two double glazed windows

Bathroom

7'10" x 5'6" (2.40 x 1.70)

The bathroom has a bath with shower attachment, low level flush WC, hand basin, laminated flooring and a double glazed window

First Floor:

Landing

The landing has loft access, a double glazed window and provides access to the first floor accommodation

Master Bedroom

16'0" x 12'1" (4.90 x 3.70)

The main bedroom has two double glazed windows and a storage cupboard

Bedroom Two

11'5" x 8'10" (3.50 x 2.70)

The second bedroom has a double glazed window

Bedroom Three

8'2" x 6'10" (2.50 x 2.10)

The third bedroom has a double glazed window overlooking the garden

Outside:

Front

To the front of the property there is a lawned garden and a range of plants and shrubs

Rear

To the rear of the property there is a private enclosed garden mainly laid to lawn and a garden shed

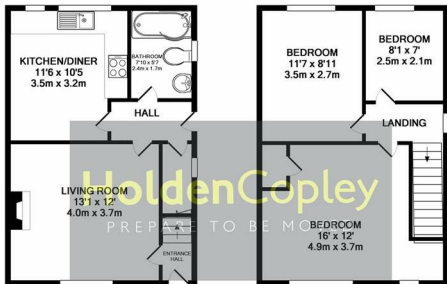

GROUND FLOOR
APPROX. FLOOR AREA 376 SQ. FT.
(34.9 SQ. M.)

1ST FLOOR
APPROX. FLOOR AREA 378 SQ. FT.
(34.9 SQ. M.)

TOTAL APPROX. FLOOR AREA 752 SQ. FT. (69.8 SQ. M.)

Whilst every attempt has been made to ensure the accuracy of the floor plan contained here, measurements of doors, windows, rooms and any other items are approximate and no responsibility is taken for any error, omission, or mis-statement. This plan is for illustrative purposes only and should be used as such by any prospective purchaser. The services, systems and appliances shown have not been tested and no guarantee as to their operability or efficiency can be given.

Made with Metropix (2017)

